

Here's a Sneak Peek of the 2023 Kips Bay Decorator Show House in New York

After a three-year hiatus, the celebrated design event will open on May 11.

BY GRACE HAYNES PUBLISHED: APR 26, 2023



Courtesy of Janice Parker Landscape Architects

The acclaimed Kips Bay Decorator Show House New York is returning to Manhattan next month for the 48th year. This highly anticipated design event, which doubles as a fundraiser for the Kips Bay Boys & Girls Club, will open its doors to the public for one month beginning on Thursday May 11, 2023, after a three-year hiatus. Twenty-two of the country's top designers and architects are hard at work transforming the historic River Mansion on the Upper West Side. Situated beside Riverside Park, the 1902 building offers enchanting views of the Hudson River and has been home to notable residents including actress Julia Marlowe and the Bronfman family. Here, we're offering a sneak peek of the inspiring spaces sure to make design enthusiasts even more excited for opening day. For tickets and more information, visit the Kips Bay Decorator Show House website.



Courtesy of Ahmad Abouzanat

PROJECT AZ's "Untitled"

"The room is a marriage of materials celebrating the beauty in less; an ode to simplicity as a romantic, understated luxury," says New York interior designer Ahmad AbouZanat. Rust-colored tiles, a nod to the home's historic facade, separates the serene escape. "Between a set of European-style wooden shutters, a cool breeze whistles through the window allowing one's thoughts to wander and providing a moment for meditative breath; to reflect on deep thoughts," he adds.



Courtesy of Fairfax Dorn Projects

Fairfax Dorn Projects' "Impressions of Pompeii"

Inspired by the soothing tones of an Art Deco-inspired wallpaper, Fairfax Dorn Projects brings together contemporary design ideas with vintage furniture and lighting in this renovated laundry room to create a calming space, showcasing that utility areas can be elevated with the same attention to detail as spaces for entertaining.



Courtesy of Sawyer Berson

Sawyer | Berson's "Marlowe Lounge"

New York-based firm Sawyer Berson will reimagine a lounge.



Courtesy of Clive Lonstein

Clive Lonstein Inc's "The Dressing Room"

New York-based interior designer Clive Lonstein will transform a bedroom into a fantasy dressing room, filling the space with the room with pieces by some of his favorite artisans, craftsmen and vendors with particular inspiration drawn from 1940s design and the rich materials and textures evocative of the time period.



Courtesy of David Scott Interiors

David Scott Interiors' "The Parlor"

New York-based interior designer David Scott was inspired to create a modern parlor for lively conversations and entertaining. Featuring curated, elegant furnishings and fine art from the 1930s to the present, he envisioned an inviting and light atmosphere where memories are meant to be made and cherished. The design will reflect the refined taste of a collector and traveler by showcasing unique, well-crafted, and culturally diverse pieces that tell a story and bring a sense of worldly sophistication.



Courtesy of Yellow House Architects

Yellow House Architects' "When Marlowe Was in Bloom"

Yellow House Architects' grand foyer and main stair hall is an ode to the actress Julia Marlowe, River Mansion's first occupant. "Upon entering the home, guests organically experience dance-like movement through light and shadow. The design team anchored the room with a chandelier entwined by living, twisted branches. Moving forward, the light draws guests to the grand staircase, where free-flowing waves of plaster curve above each step— serving as a counterpoint to traditional wainscoting," says Elizabeth Graziolo.

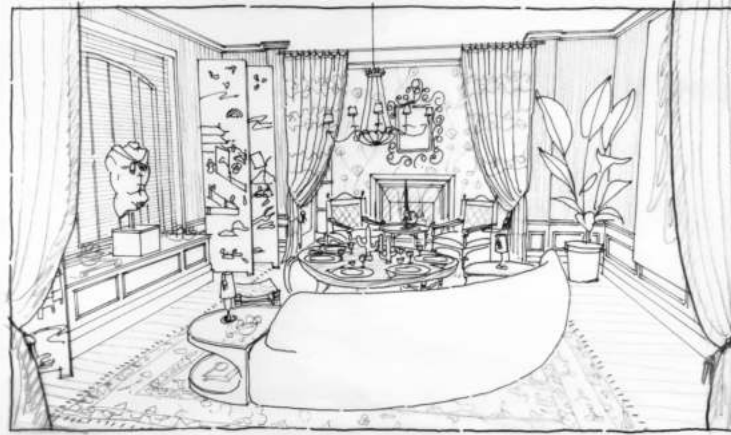

Courtesy of Georgis & Mirgorodsky

Georgis & Mirgorodsky's Dining Room

Georgis & Mirgorodsky will conjure the Levant—a geographical, cultural, and metaphysical region bridging Europe, Asia, and Africa—in this atmospheric dining room. "Our room is inspired by historic interiors of Cairo, Istanbul, and Damascus—places which enjoyed periods of cross-cultural pollination, and a co-mingling of Eastern and Western sensibilities," say partners William Georgis and Ilya Mirgorodsky.



Courtesy of Ghislaine Viñas

Ghislaine Viñas' "Good Spirits"

"Our room draws from the history of River Mansion and its inhabitants. We thought to first dress the walls in a modern take on an old classic. Plaid wallpaper seemed so fitting. Of course, to mix things up, we invited one of our favorite artists Mark Mulroney to add his signature, unique flair to the walls, telling an unexpected story using paint and felt," says New York-based interior designer Ghislaine Viñas.



Courtesy of Janice Parker Landscape Architects

Janice Parker Landscape Architects' "Trees on the Hudson"

"The original character of the historic River Mansion has inspired a classic, lush planting. This allows the elaborate detailing on the 1902 Beaux-Arts brick and limestone mansard mansion to stand center stage, in a setting of symmetrical tree plantings," says landscape architect Janice Parker. "Cascading trails of ivy, flowers, rows of trees and the addition of planters with Pleached Linden Trees—known as Lime Trees in Europe—will frame the Show House entry."



Courtesy of Jay Jeffers, Inc.

JayJeffers, Inc.'s Library

"I created the space as a backdrop for small moments and as a place where memories are made. From a design perspective, the library is the perfect combination of bi-coastal living with a bit of California and New York all rolled into one," says interior designer Jay Jeffers of the room's bold, earthy palette. "I love furniture with a story, and there's no better place to bring a story to life than the library," he adds.



Courtesy of Halden Interiors

Halden Interiors' "Heart of the Vine"

"The vine symbolizes connection, friendship, strength, and determination. The intention for the design of the den in this historic Riverside Mansion was to encapsulate all these attributes through the bold and delicate moments in the room," says Kesha Franklin of Halden Interiors. "In a time where life can feel unsure, we wanted to design a space that felt protected by the beauty of nature and that evokes passion."



Courtesy of Lillian Wu Studio

Lillian Wu Studio's "Wilderness"

"In the hospitality world, we refer to the service pantry as 'the heart of the home,' the blood-pumping machine that gives the house life," says New York-based interior designer Lillian Wu. To bring romance and warmth into a typically dark space, she turned to a tropical wallpaper for inspiration. "The large, beautiful leaves and dreamy forest theme will dictate some of the palette and color choices for the cabinetry, as well as artwork selections."

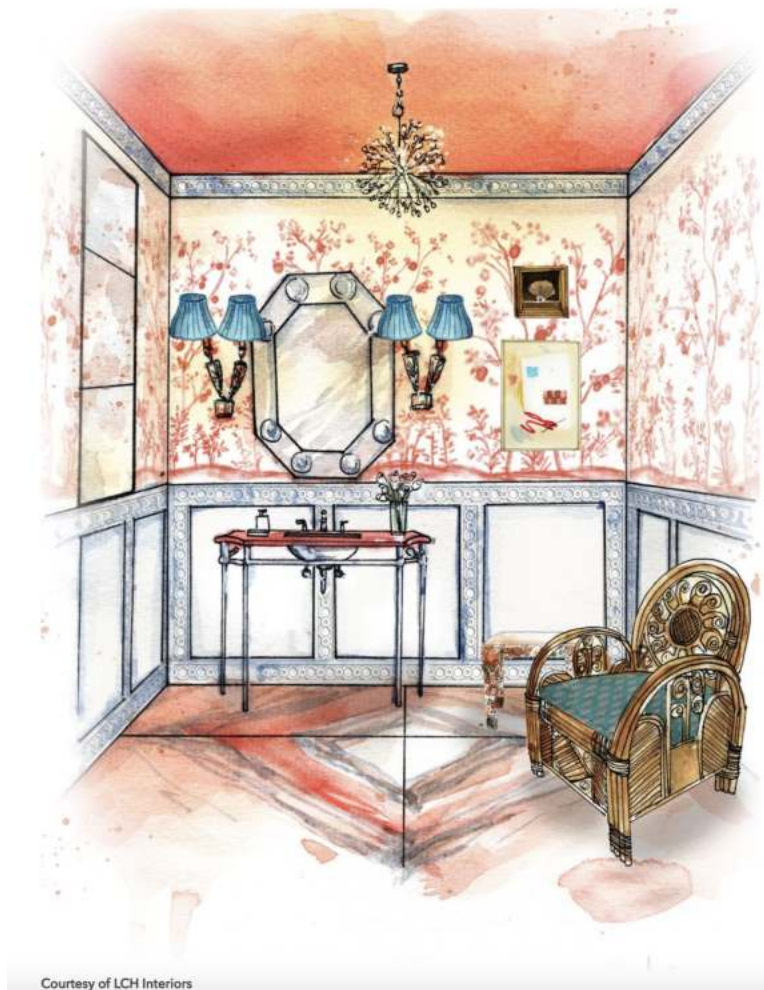

Courtesy of LCH Interiors

LCH Interiors' "Lindsey's Loo"

Designer Lindsey Coral Harper conjured grandmillennial powder room, fit for a queen, with a chic and glamorous granny vibe. "The perfect place to powder your nose!" she adds.



Courtesy of Neal Beckstedt Studio

Neal Beckstedt Studio's "Drawing Room"

"The home is generously sized with numerous spaces to accommodate primary programming, so our space could be used for pure indulgence and play. We envisioned the room as a traditional architect's drawing room; a space for solace, focus, and leisure," says designer Neal Beckstedt.



Courtesy of Penny Drue Baird, Dessins LLC

Penny Drue Baird, Dessins LLC's "Upper West Side Story"

"'Upper West Side Story' is about the belle époque elegance coupled with the relaxed vibe New York's West side conjures up. Today, relaxed and comfortable is a universal desire. Here, our mixture of soft palette, sumptuous fabrics and finishes, and rich furnishings combine to create a perfect surround or inviting escape," says designer Penny Drue Baird of her sitting room.



Courtesy of Sasha Bikoff

Sasha Bikoff Interior Design's "Flight of Fantasy"

"'Flight of Fantasy' takes you on a journey through a primary bedroom inspired by nature's skies, water, and earth," says designer [Sasha Bikoff](#). The gold leaf and pastel-hued wallpaper will inform the bedroom's scheme. "The color palette is reminiscent of Rococo paintings and a box of macaroons. The wallpaper's serene pattern makes you feel as though you're floating on a cloud."

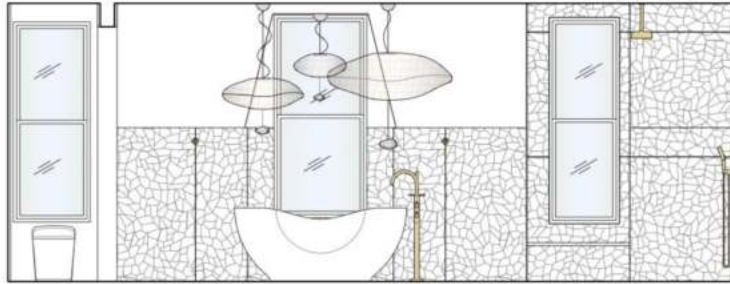

Courtesy of Sergio Mercado Design

Sergio Mercado Design's Primary Bath

“Our concept for the primary bath was to design a space that felt ethereal and transcendent. A peaceful space for slow living, and a special place where you can escape for quiet time. We called on a tonal mix of visual texture created by lightly white-washed slatted wood and custom laser carved marble of the same color,” says New York-based designer [Sergio Mercado](#).



Courtesy of Design Studio 15

Design Studio 15's "The Shapes of Design"

“Our space was inspired by the energy of New York City and elements experienced here daily. The shapes of buildings, color explorations and the perpetual motion the soul of the city provides,” says Orlando-based designer [Shanna Gatanis](#). “We tapped into a playful palette of colors for this room to inspire visitors to feel energized and provoked by organic shapes.”



Courtesy of Timothy Corrigan

Timothy Corrigan Inc.'s "Spring Fever"

"In all of our projects, we strive to create spaces that are comfortably elegant: where people feel that they are someplace special, while simultaneously feeling completely at ease. To that end, outdoor fabrics were used on the upholstered seating, along with a stain-resistant hide rug, to live up to the demands of an active family. The soft color palette and elements of nature create a light, bright haven that counterbalances life in an urban setting. The result is a calmer and more joyful way of living," notes designer Timothy Corrigan of the family room.



Courtesy of Wesley Moon, Inc.

Wesley Moon, Inc.'s "Not Just a Kitchen"

"I was inspired by The River Mansion and its Edwardian roots. I wanted the space to feel like an updated version of the kitchen that may have been original to the house," says interior designer Wesley Moon. "As a nod to the early 1900s, we will incorporate details like the custom plaster crown moulding. The china cabinet, displaying serving pieces and a mix of antique and contemporary vessels, also recalls memories of historic butler's pantries."